

Holbourne Construction Swords Ltd

18/12/2019

To whom it may concern,

We confirm our Agreement/Consent for Rycroft Homes Ltd to make an SHD Planning Application to An Bord Pleanala on our Lands as per the attached Map.

Yours sincerely,
Holbourne Construction Limited

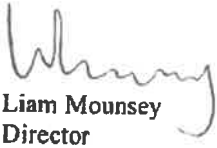
Liam Mounsey
Director

Telephone: 01 - 8829858/9
Facsimile: 01 - 8829971

1a MPO Building, Blanchardstown Business Park,
Snugborough Road, D15

Registered in Ireland No. 285398
Vat No. 8295398E

The copyright of this drawing is vested with Corstorphine & Wright Ltd and must not be copied or reproduced without the consent of the company.

Figured dimensions only to be taken from this drawing. DO NOT SCALE. All contractors must visit the site and be responsible for checking all setting out dimensions and notifying the architect of any discrepancies prior to any manufacture or construction work.

NOTES:

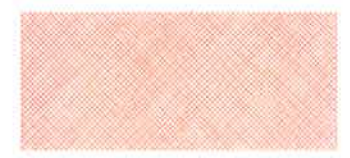

Land in Ownership of
Holbourne Construction
Swords Ltd

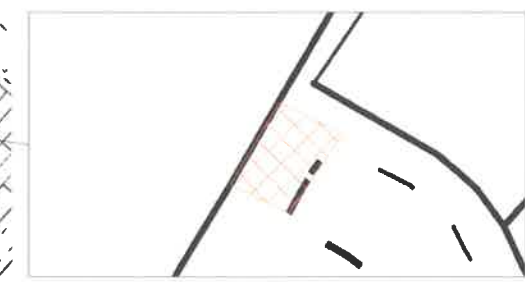

Extract Area A
1:500 @ A3

Rev. Date Initial Notes

K Planning Issue

Client
Rycroft Homes Ltd.
Project
Residential Development
Lands Adjoining Brayton Park,
St. Kilcock, Co. Kildare

Drawing Title
Land Ownership
Holbourne Construction Swords Ltd

Drawn
kr
Checked
pu
Paper Size
A3
Scale
1:2500 @ A3
Date
11-19

Project No
17-100
Drawing No
114
Sheet
A

C+W O'BRIEN
ARCHITECTS
No 1 Sarsfield Quay, Dublin 7, D07 R9F1
T 01 518 0170 E admin@cwarchitects.ie
Dublin | London | Warwick | Manchester
www.cwarchitects.ie

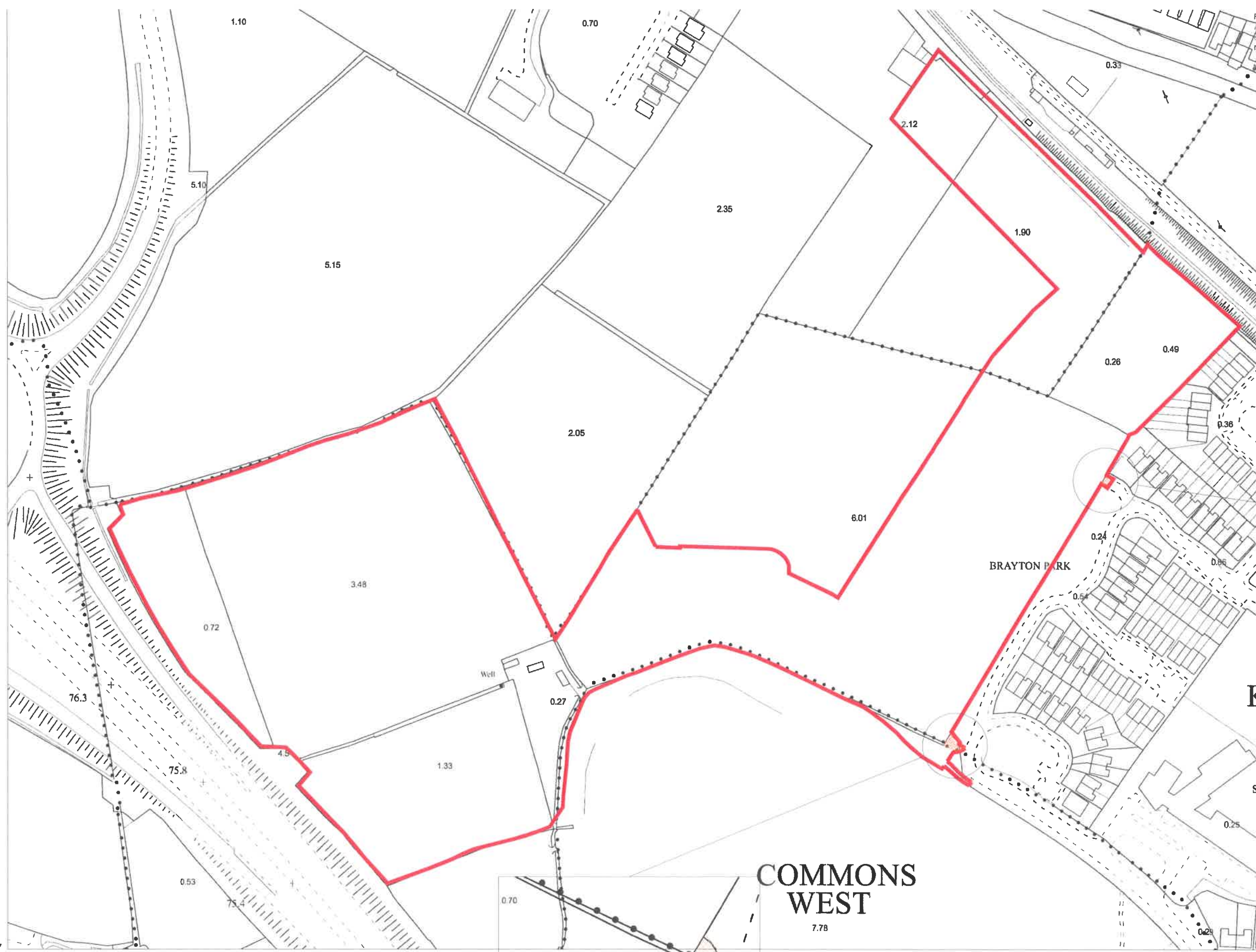

Land Ownership Map
1:2,500 @ A3

COMMONS WEST
7.78

Extract Area B
1:500 @ A3

