

Note:  
North point varies  
refer to Site Plan

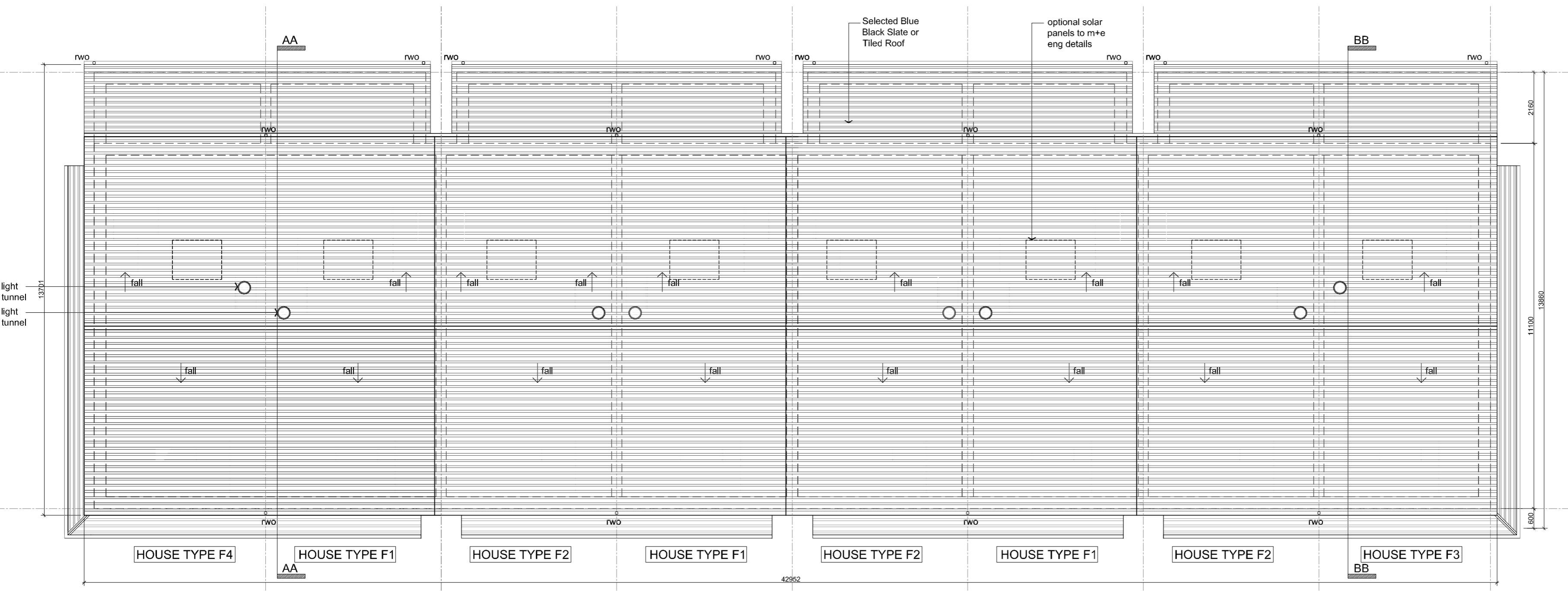

03 ROOF PLAN  
SCALE: 1:100

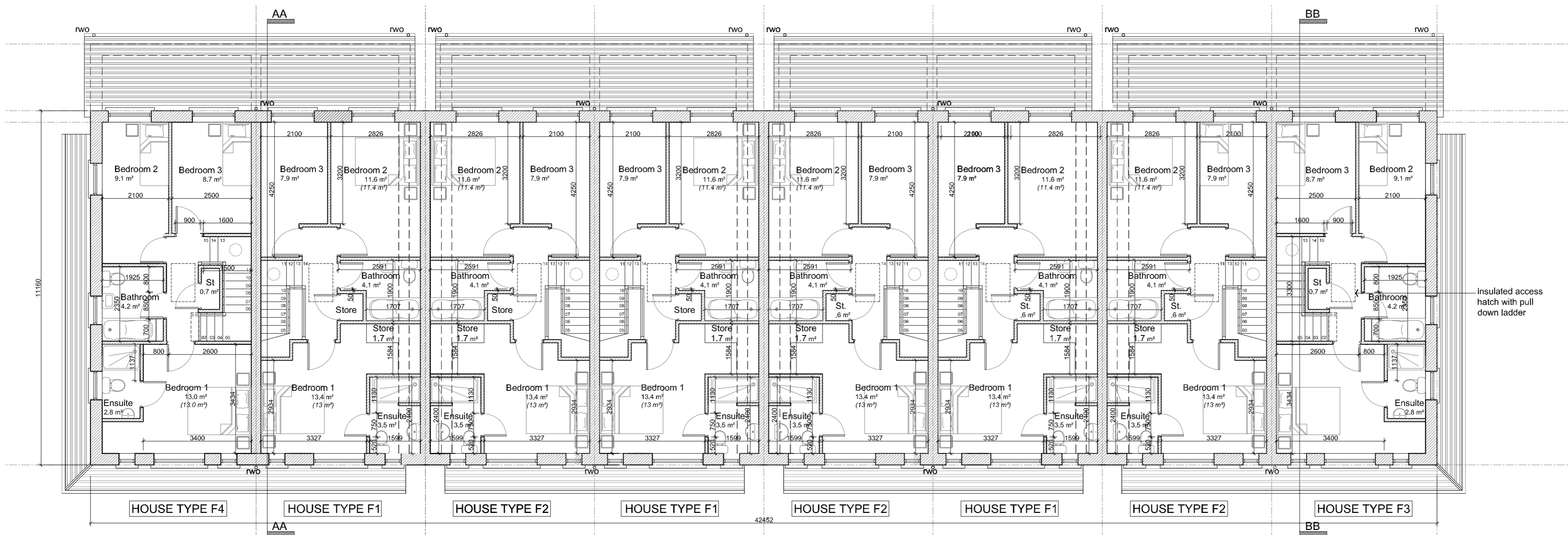

02 FIRST FLOOR PLAN  
SCALE: 1:100

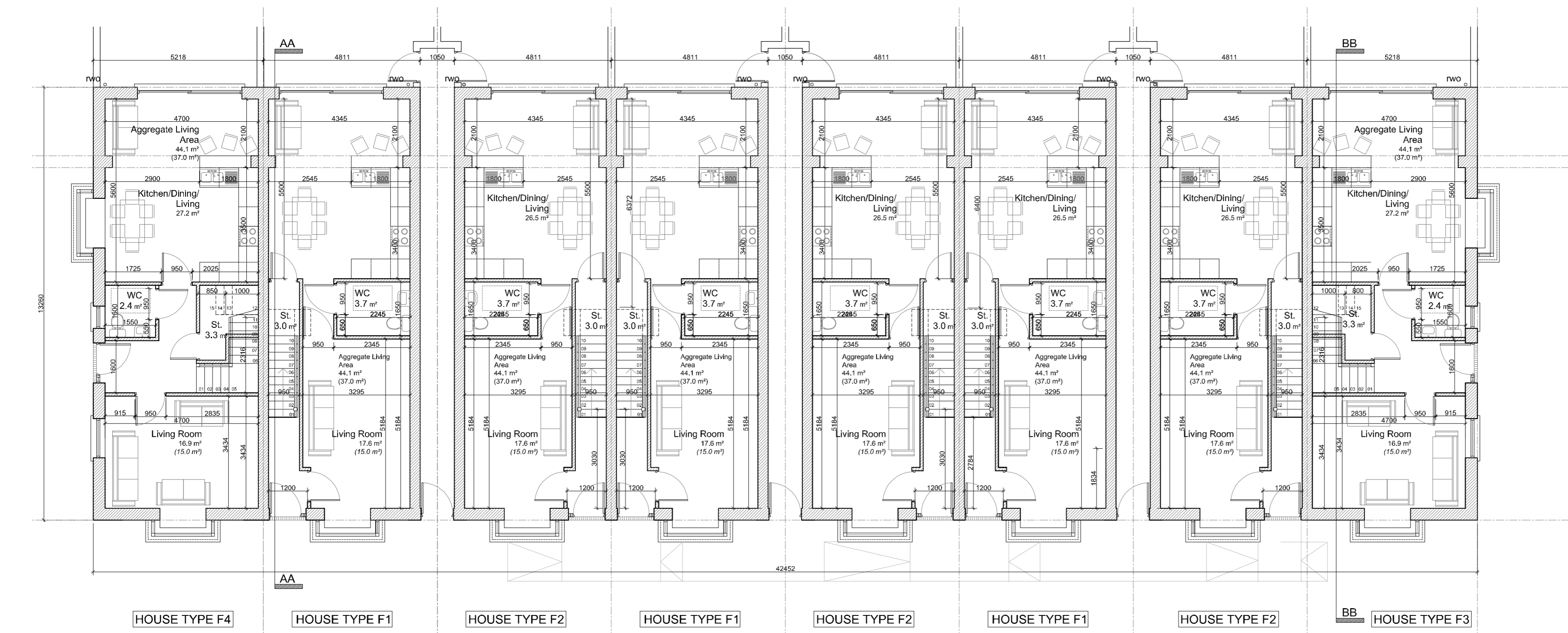

01 GROUND FLOOR PLAN  
SCALE: 1:100

<b>House Type F1 &amp; F2</b> 3 Bed 5 Person Semi Detached
Ground Floor Area 55.4 m <sup>2</sup> 596.3 R <sup>2</sup>
First Floor Area 52.4 m <sup>2</sup> 564.0 R <sup>2</sup>
Overall Floor Area 107.8 m <sup>2</sup> 1,160.3 R <sup>2</sup>
<b>House Type F3 &amp; F4</b> 3 Bed 4 Person Semi Detached
Ground Floor Area 60.8 m <sup>2</sup> 654.4 R <sup>2</sup>
First Floor Area 49.0 m <sup>2</sup> 527.4 R <sup>2</sup>
Overall Floor Area 109.8 m <sup>2</sup> 1,181.8 R <sup>2</sup>

A	05/20	AC	Issued for Planning.
Rev	Date	Initial	Notes

SHD Issue

Client:  
Romeville Developments Ltd.

Project:  
Proposed Residential Development  
Stoney Hill Road, Rathcoole,  
Co. Dublin

Drawing Title:  
House Type F1, F2, F3 & F4  
Block B  
Plans

Drawn	Checked	Paper Size	Scale	Date
SP	PU	A1	1:100	May 2020
Project No.	Drawing No.	Revision		
17-098	312	A		