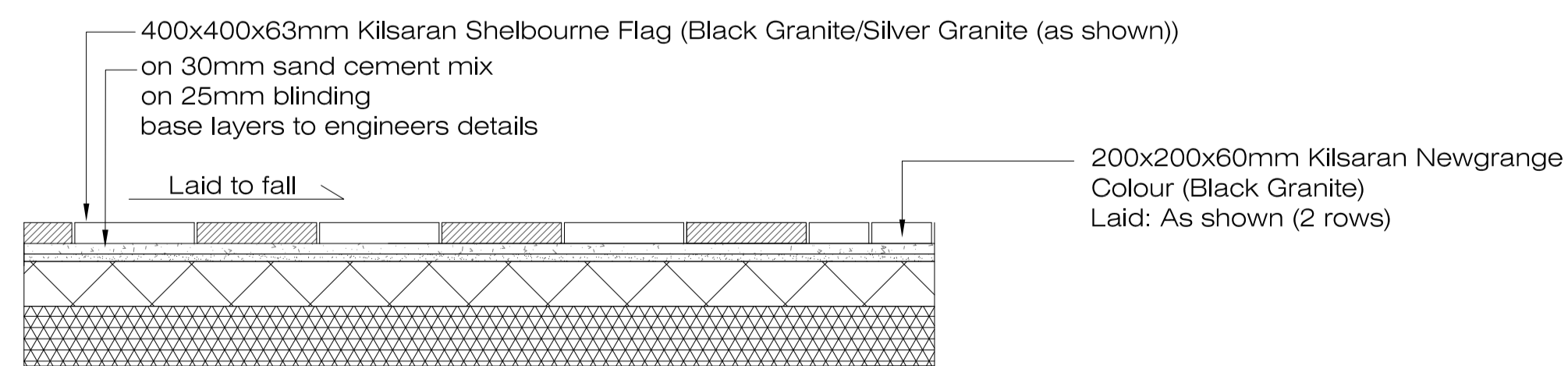
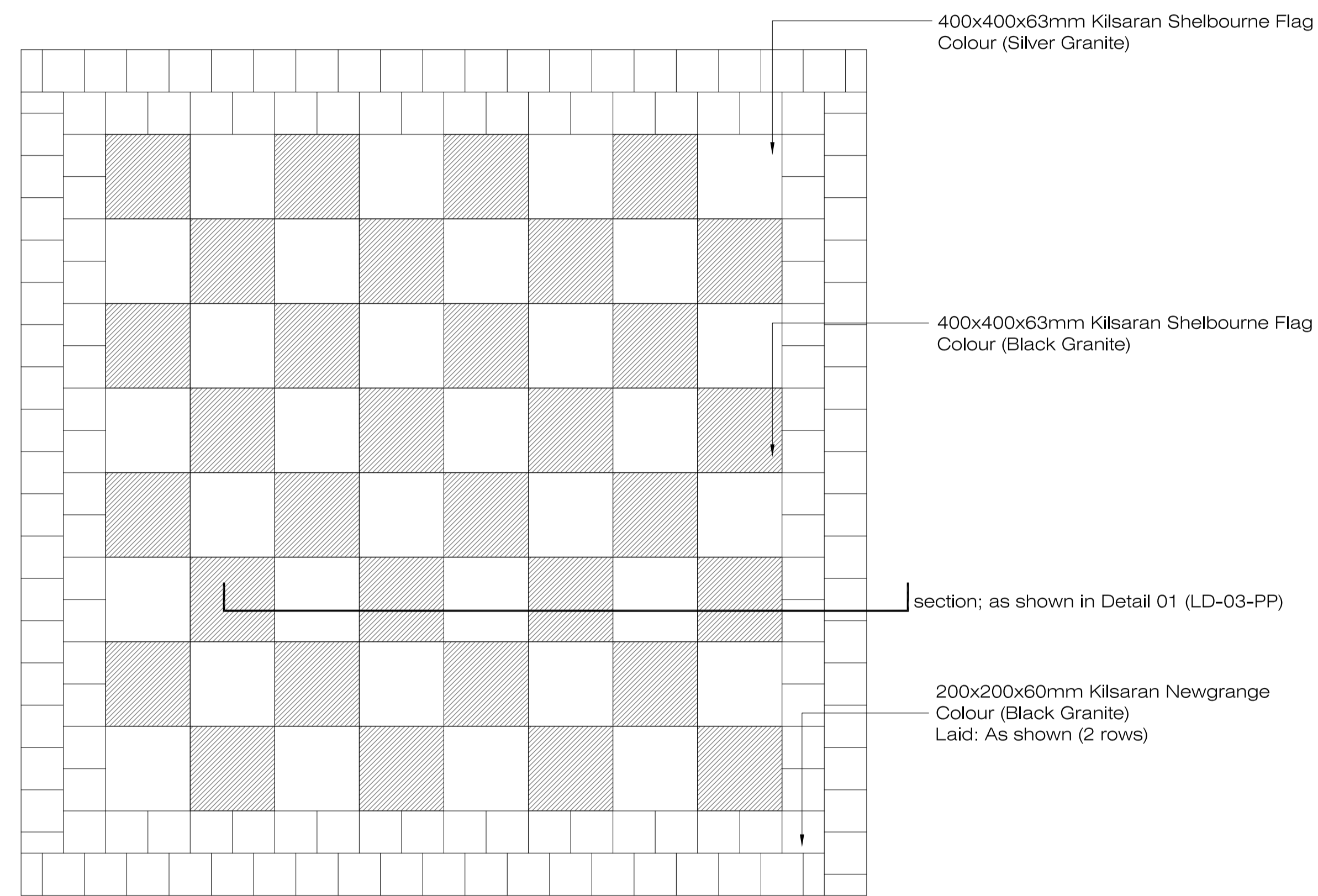
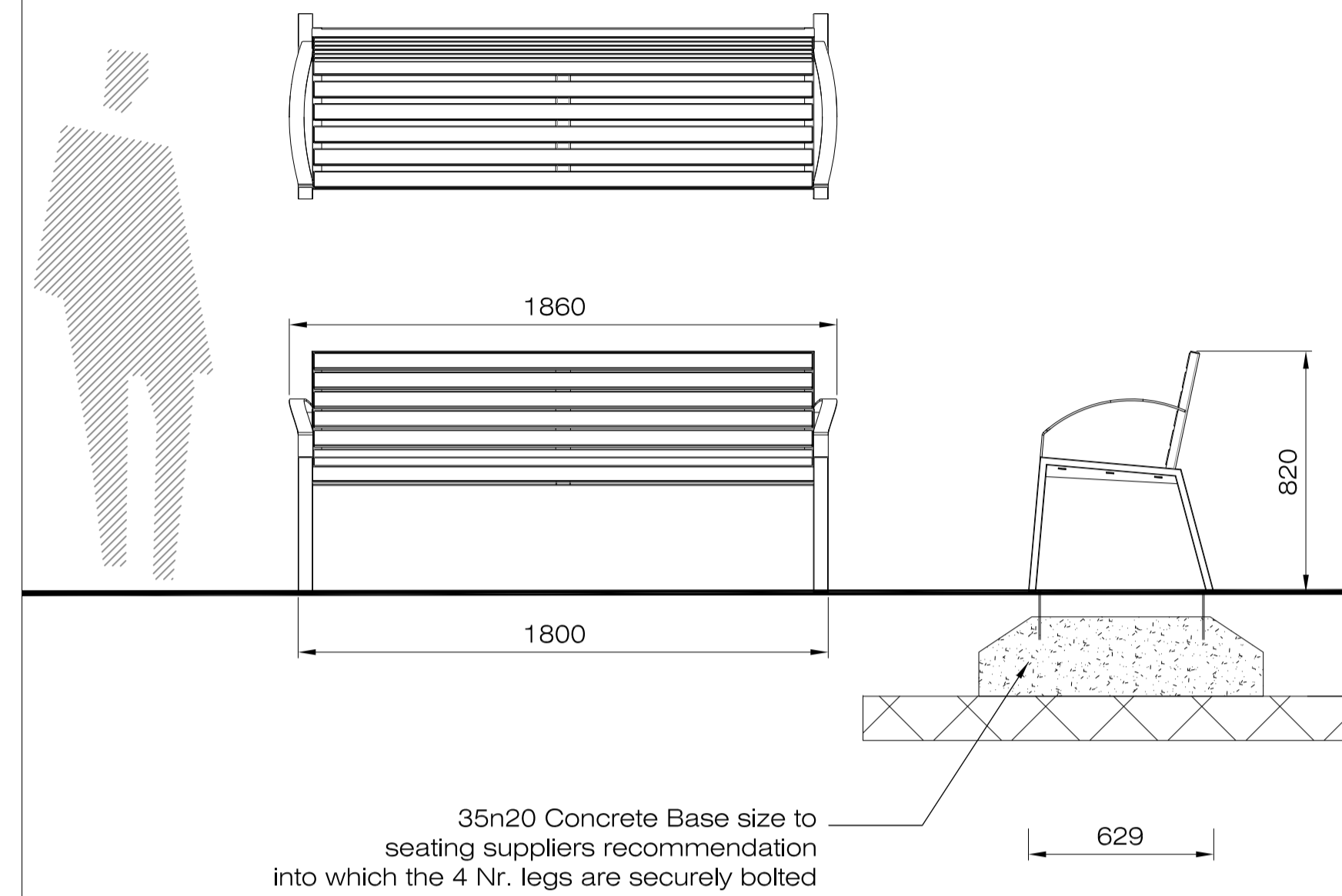



Image of proposed Chessboard



D 01 LD-03-PP Chessboard within central courtyard.
Scale @ 1:20



Detail 02 Dwg LD-03-PP Omos s59.2 seat
Scale @ 1:20

Addagrip Resin bound gravel permeable surface.

Surface course hand applied and trowelled
3mm aggregate formulation to a depth of 16mm
6mm aggregate formulation to a depth of 18mm
10mm aggregate formulation to a depth of 24mm

Binder course
50mm depth of AC 14 close surface asphalt concrete
max 160/220 pen to BS EN 13108-1:2006 (Bituminous macadam)

Sub base
150mm depth of well compacted non frost susceptible type 1 granular sub base to SHW clause 803

on sub grade base layer.

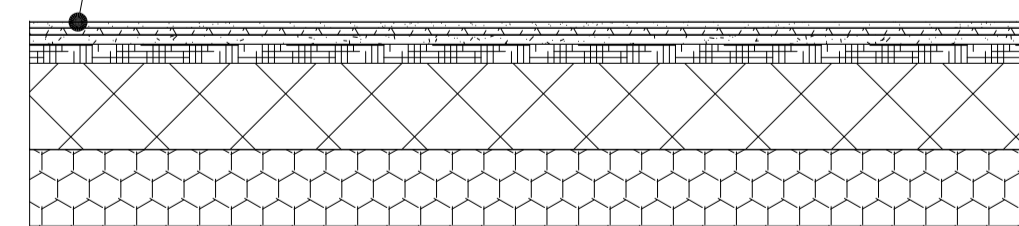

Detail 03 Dwg LD-03-PP Addagrip resin bound gravel
Scale @ 1:20

Rev.	Date	Note

Project name: Residential Development, Stoney Hill Road, Rathcoole	Project number: 18-008
Drawing name: Hard Landscape Details 01	Drawing number: LD-03-PP

Drawing scale @ A1: 1:20	Drawn by: kg	Checked by: ld
Status: Planning	date: 28.04.2020	

Contact details: Linda Doyle (Director) mobile: 087 267 4196 e-mail: linda@doyle-otroithigh.com Daire o'Troithigh (Director) mobile: 086 300 3499 e-mail: daire@doyle-otroithigh.com	Office address: Pembroke House, 28-32 Upper Pembroke St, Dublin 2.
--	---