

A PROPOSED VISIBILITY SPLAY FOR ACCESS ROAD 1
 0101 Scale: 1:200

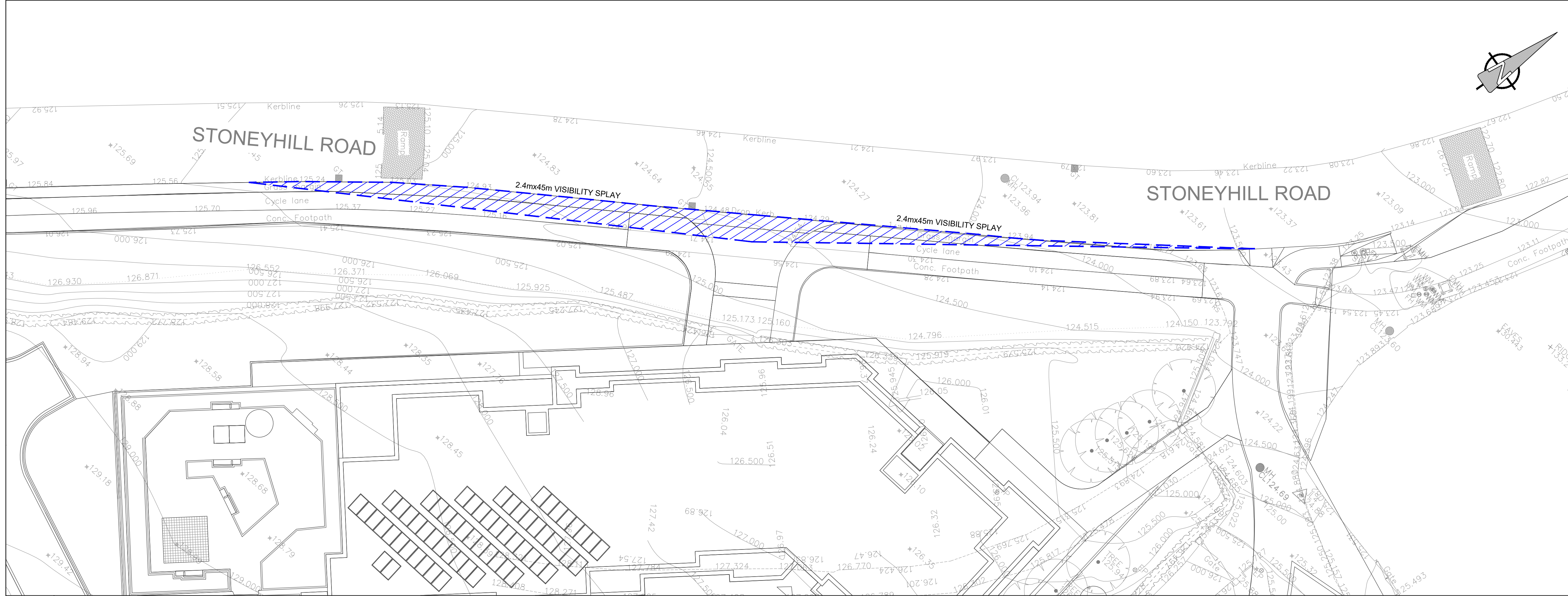

B PROPOSED VISIBILITY SPLAY FOR APARTMENT BLOCK ACCESS
 0101 Scale: 1:200



PROJECT
 PROPOSED RESIDENTIAL
 DEVELOPMENT AT LANDS AT
 STONEY HILL ROAD, RATHCOOLE,
 Co. DUBLIN

CLIENT
 ROMEVILLE DEVELOPMENTS LTD.

CONSULTANT
 AECOM
 4th Floor Adelphi Plaza,
 George's Street Upper,
 Dun Laoghaire,
 Co Dublin
 Tel: +353 (0)1 2383100
 Fax: +353(0)1 2383199
 www.aecom.com

- NOTES**
1. THIS DRAWING IS TO BE READ IN CONJUNCTION WITH ALL OTHER RELEVANT ARCHITECTURAL AND ENGINEERING DRAWINGS. ANY DISCREPANCIES, ERRORS OR OMISSIONS TO BE BROUGHT TO THE ATTENTION OF THE DESIGNER.
 2. ALL DIMENSIONS TO BE CHECKED BY THE CONTRACTOR ON SITE PRIOR TO COMMENCEMENT OF WORKS.
 3. AECOM LIMITED TO BE INFORMED BY THE CONTRACTOR OF ANY DISCREPANCIES PRIOR TO THE COMMENCEMENT OF WORKS ON SITE.
 4. DIMENSIONS OF ALL BOUNDARIES AND ADJOINING ROADS TO BE CHECKED ON SITE PRIOR TO COMMENCEMENT OF WORKS.

ISSUE/REVISION		
NO	DATE	DESCRIPTION
3	01.05.2020	FINAL SUBMISSION TO ABP
2	10.10.2019	ISSUED FOR PLANNING TO ABP
1	08.10.2019	ISSUED FOR PRE-APP TO ABP
0	28.08.2019	DRAFT ISSUE
I/R	DATE	DESCRIPTION

PROJECT NUMBER
 60578132

SHEET TITLE
 PROPOSED VISIBILITY SPLAYS

SHEET NUMBER
 PR305837-ACM-01-00-DR-CE-10-0101

This drawing has been prepared for the use of AECOM's client. It may not be used, modified, reproduced or relied upon by third parties, except as agreed by AECOM or as required by law. AECOM accepts no responsibility, and denies any liability, whatsoever, to any party that uses or relies on this drawing without AECOM's express written consent. Do not scale this document. All measurements must be obtained from the stated dimensions.