

NOTE  
 ALL DIMENSIONS TO BE CHECKED ON SITE  
 NO DIMENSIONS TO BE SCALED FROM THIS DRAWING  
 THIS DRAWING IS TO BE READ IN CONJUNCTION WITH  
 RELEVANT CONSULTANTS DRAWINGS

### DEMOLITION LEGEND

- ORIGINAL FABRIC PROPOSED FOR REMOVAL**  
 Structural fabric from the original 1924 Factory proposed for careful removal in accordance with conservation specifications ■■■■■
- NON-ORIGINAL FABRIC PROPOSED FOR REMOVAL** ■■■■■
- NON-LOAD BEARING WALLS AND DOORS PROPOSED FOR REMOVAL** ■■■■■
- ORIGINAL FABRIC PROPOSED FOR REMOVAL**  
 Structural slabs required to be removed to allow for new structures to be constructed or new slab to be infilled ▣
- Structure to be retained**

REV	DATE	DESCRIPTION	CHKD	DRN
A	DEC 2020	ISSUED FOR PLANNING	BF	AR

**PLANNING**

**Henry J Lyons**

Architecture + Interiors +353 1 888 3333 51-54 Pearse Street  
 henryjlyons.com info@henryjlyons.com Dublin D02 KA66

**KPF** Kohn Pedersen Fox Associates  
 (International) PA  
 Architects and Planning Consultants  
 75 Ludlow Street  
 London WC2E 8JA  
 England  
 T: +44 (0) 20 7467 1175  
 http://www.kpf.com

CLIENT  
**DBTR-SCR1 Fund**

PROJECT  
**SHD on the former Player Wills Site  
 and Dublin City Council Lands at  
 South Circular Road, Dublin 8**

JOB NUMBER:	950578
DATE:	MARCH 2020
SCALE:	1:200 @A1
DRAWN:	RMD
CHECKED:	BF
FILE NAME:	950578 X- PL0100 PW_Demolitions

DRAWING  
**PW1 DEMOLITION  
 REFLECTED CEILING PLANS  
 LEVELS 02, 03**

BLOCK	DRAWING NUMBER	ZONE	REVISION
	PL0104		A

© Henry J Lyons

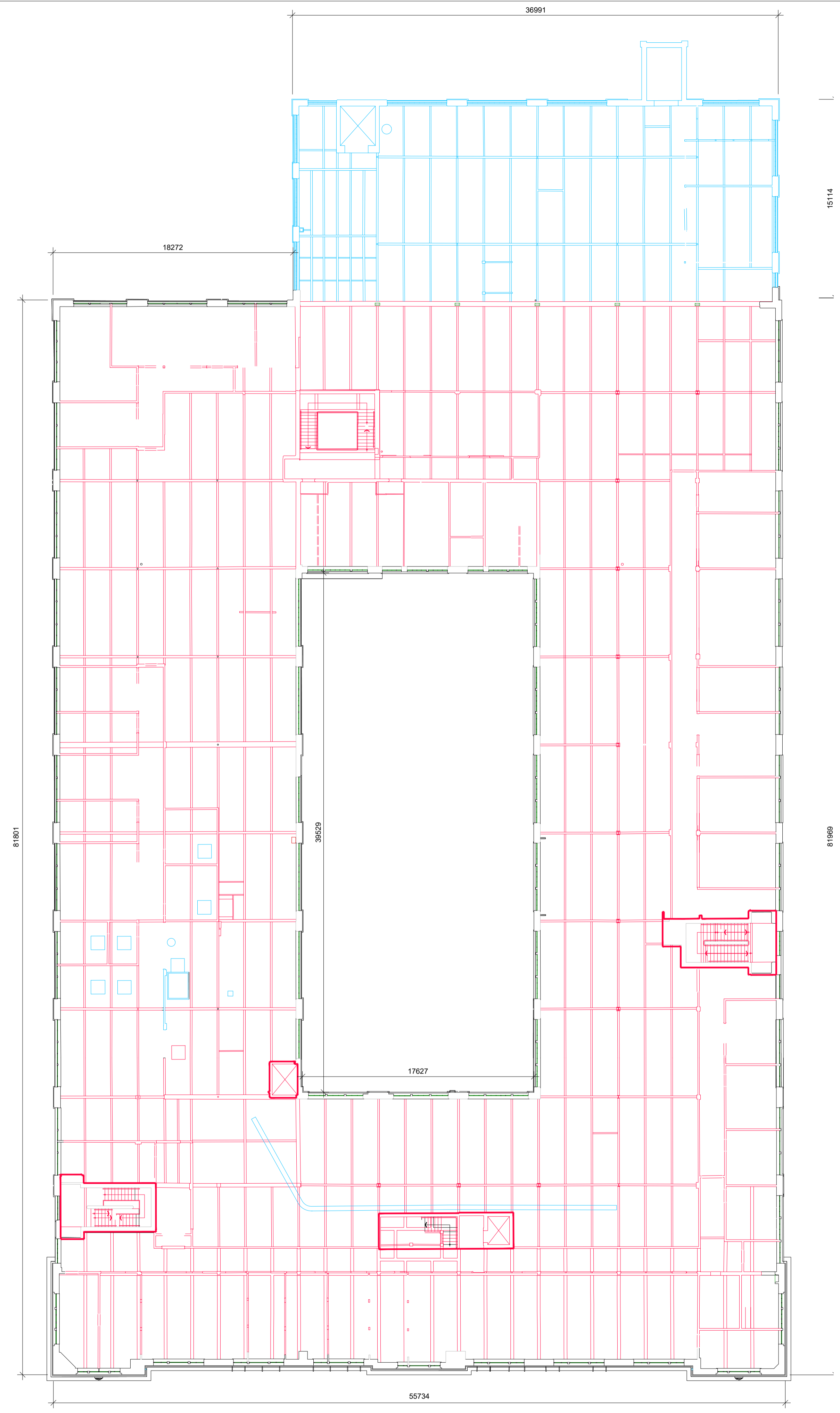

**01** Second Floor RCP PW1  
 PL0104 SCALE 1:200

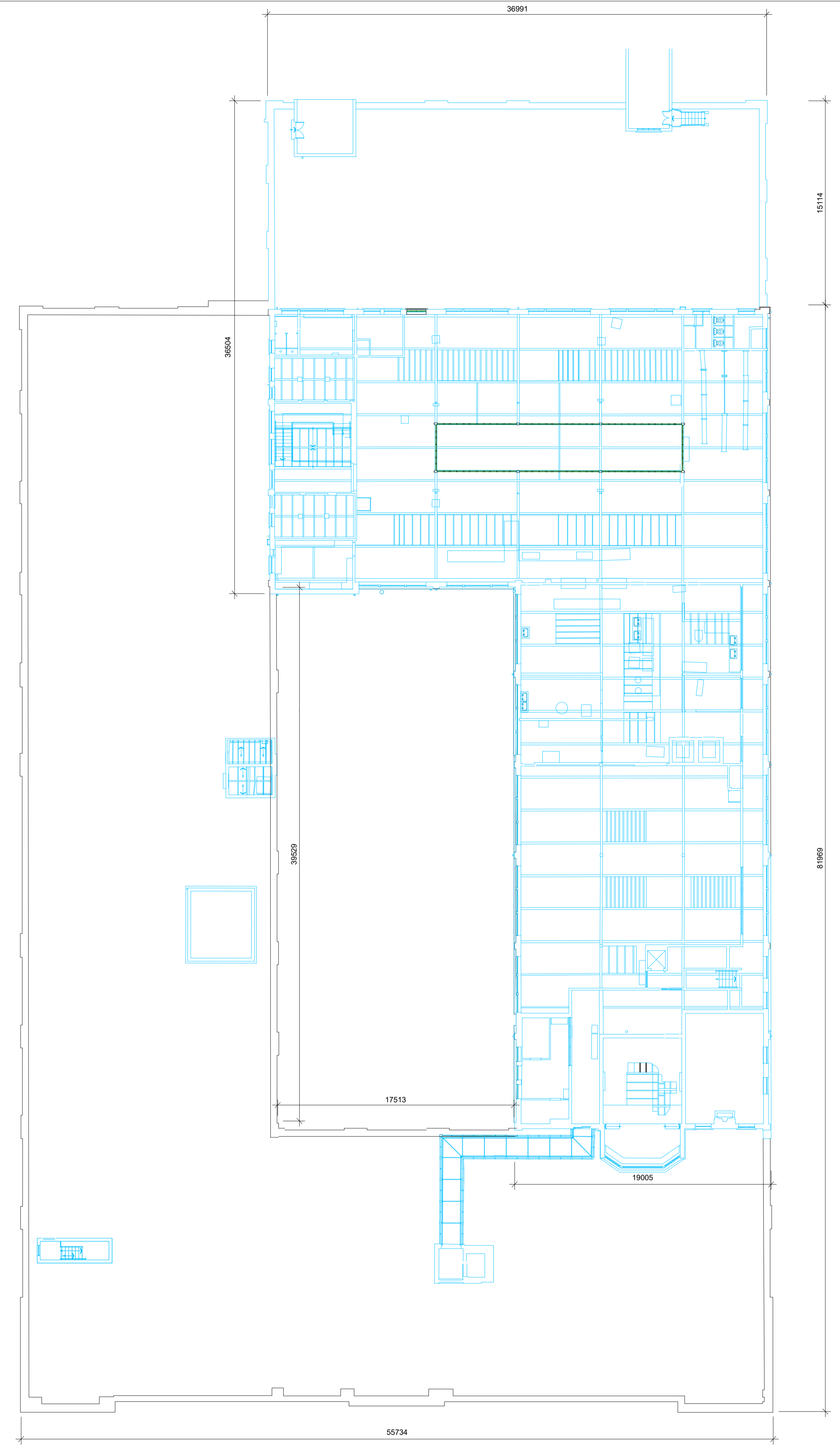

**02** Second Floor RCP PW1  
 PL0104 SCALE 1:200