

PERMITTED SITE LAYOUT PLAN 1:500@A1  
(A.B.P. ref. 300241-17 AUGUST 2018)

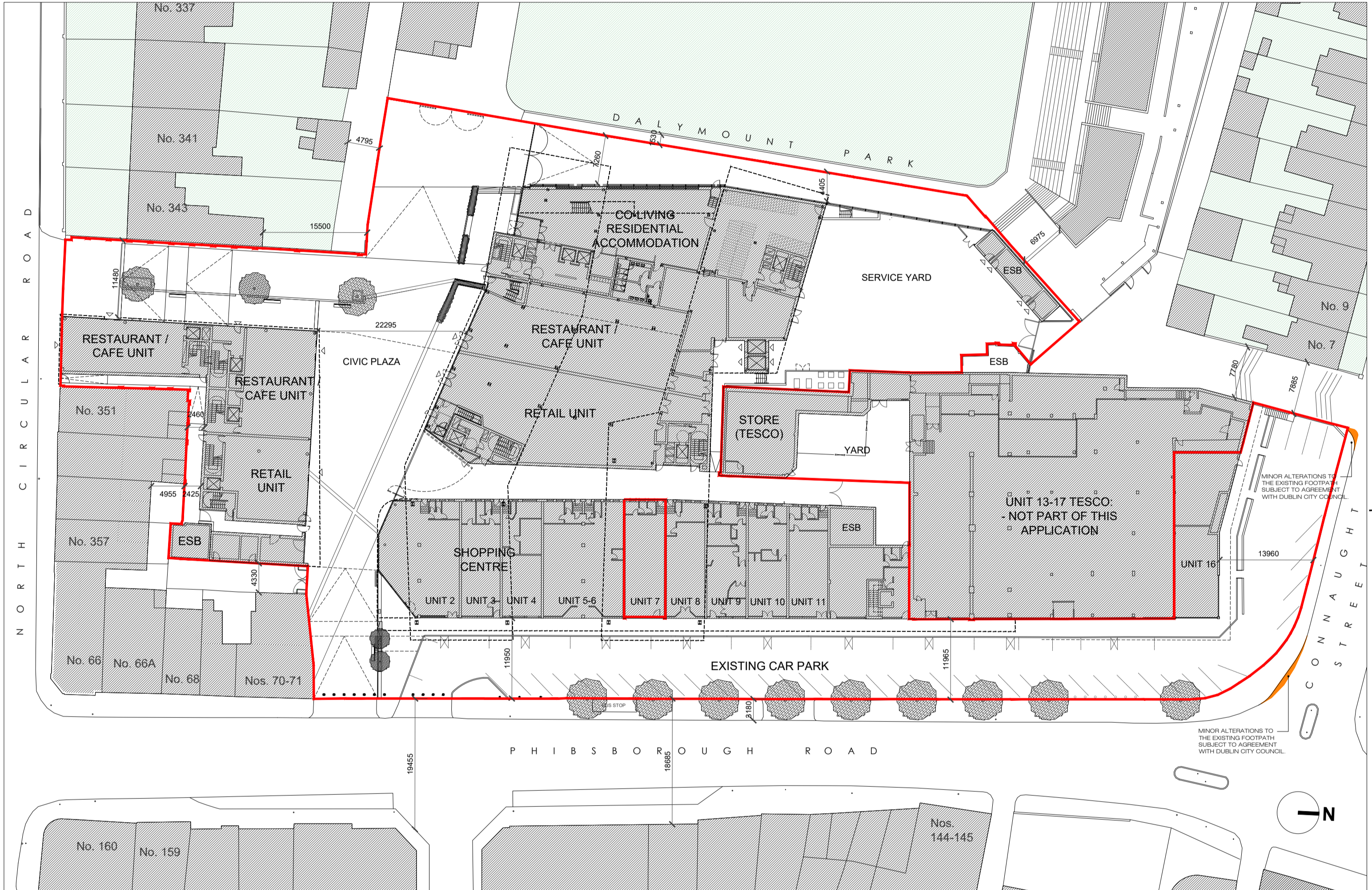

PROPOSED SITE LAYOUT PLAN 1:500@A1

**GENERAL NOTES**

1. THIS DRAWING IS FOR PLANNING APPLICATION PURPOSES ONLY.
2. THIS DRAWING SHALL BE READ IN CONJUNCTION WITH ALL ACCOMPANYING DRAWINGS/REPORTS SUBMITTED WITH THE PLANNING APPLICATION. ANY DISCREPANCIES TO BE NOTIFIED TO DONNELLY TURPIN ARCHITECTS.
3. ALL DIMENSIONS INDICATED ARE SUBJECT TO SITE SURVEY.
4. COPYRIGHT RETAINED BY DONNELLY TURPIN ARCHITECTS.

REV.#	DATE	NAME	NOTES
-	-	-	-
-	-	-	-
-	-	-	-
-	-	-	-

PROJECT PHIBSBOROUGH SHOPPING CENTRE NEW DEVELOPMENT & REFURBISHMENT OF EXISTING CENTRE			
<b>DONNELLY TURPIN ARCHITECTS</b> 56 CAMDEN STREET LOWER, DUBLIN 2 TEL: (+353) 1 475 9065 FAX: (+353) 1 4988564 E-MAIL: projects@donnellyturpin.com			
STAGE PLANNING	SCALE 1:500 @ A1	DRAWING PERMITTED AND PROPOSED SITE LAYOUT PLANS	
JOB NO. 1826	DWG NO. P 01_02	REV. -	DATE NOVEMBER 2020