

REV. NO.	REV. DESCRIPTION	REV. DATE	DRAWN	CHECKED
D1	DRAFT ISSUE	17/01/2020	EBR	AG
D2	REVISED DRAFT ISSUE	21/01/2020	EBR	AG
P1	PLANNING ISSUE	16/04/2020	BD	AG
P2	CONNECTION DIAMETER INCREASED	08/06/2020	JP	JP
P3	OUTFALL GRADIENT UPDATED	12/06/2020	JP	JP
P4	ATTENUATION CONNECTION UPDATED	08/09/2020	AG	JP
P5	BACKGROUND UPDATED SCHEME REVISED	11/2/2020	AG	JP
P6	ATTENUATION TANK UPDATED	07/12/2020	AG	AG

DRAINAGE LEGEND	
	FOUL SEWER (EXISTING)
	FOUL SEWER (NEW)
	FOUL SEWER (SLUNG FROM GROUND FLOOR SLAB)
	SURFACE WATER SEWER (EXISTING)
	SURFACE WATER (SLUNG FROM GROUND FLOOR SLAB)
	SURFACE WATER SEWER (NEW)
	GREY WATER SEWER (EXISTING)
	GREY WATER SEWER (NEW)
	FOUL SEWER RISING MAIN
	SURFACE WATER RISING MAIN
	GREY WATER RISING MAIN
	EXISTING SEWER TO BE DECOMMISSIONED
	EXISTING WATER MAIN
	PROPOSED WATER MAIN
	PROPOSED FLOOD PIPES
	FSMH (NEW FOUL SEWER MANHOLE)
	SWMH (NEW SURFACE WATER MANHOLE)
	NEW FIRE HYDRANT
	NEW SLUICE VALVE
	NEW AIR VALVE
	NEW WASHOUT HYDRANT
	NEW METER
	RAIN WATER DOWN PIPE
	POP UP
	SOIL VENT PIPE
	EX. FSMH (EXISTING FOUL SEWER MANHOLE)
	EX. SWMH (EXISTING SURFACE WATER MANHOLE)
	MH (EXISTING MANHOLE TO BE DEMOLISHED)
	F.S.I.C. (FOUL SEWER INSPECTION CHAMBER)
	S.W.I.C. (SURFACE WATER INSPECTION CHAMBER)
	E.I.C. (EXISTING INSPECTION CHAMBER)
	F.G. (FLOOR GULLY)
	B.I.G.T. (BACK INLET GULLY TRAP)
	ACO (ACO DRAINAGE CHANNEL)
	SURFACE WATER EXCEEDANCE FLOW ROUTE

- DRAINAGE NOTES:**
1. READ IN CONJUNCTION WITH ALL RELEVANT ARCHITECTS AND ENGINEER'S DRAWINGS.
  2. MANHOLE AND ROAD GULLY DETAILS TO COMPLY WITH DUN LAOGHAIRE-RATHDOWN COUNTY COUNCIL AND IRISH WATER'S STANDARD DETAILS.
  3. ALL PIPES TO BE WAVIN uPVC OR SIMILAR SAVE FOR SEWERS IN PUBLIC ROADWAY WHICH ARE TO BE CONCRETE.
  4. WHERE COVER TO PIPES IS LESS THAN 1.2M IN ROADS, 1.0M IN PUBLIC AREAS AND 0.8M IN GRASSED/LANDSCAPED AREAS, SURROUND THE PIPE UP TO 150MM WITH 100MM CONCRETE AND LARGER PIPES WITH 150MM CONC.
  5. BACK-FILL TRENCHES IN ROADS WITH MOT STONE COMPACTED IN LAYERS.
  6. CLOSE ROAD GULLIES IN THE DIRECTION OF TRAFFIC FLOW.
  7. ADJUST FOUNDATION DEPTHS, AS NECESSARY, ADJACENT TO SEWERS TO AVOID UNDERMINING OF THE FOUNDATIONS.
  8. DO NOT SET OUT FROM THIS DRAWING. SETTING OUT TO BE DONE FROM ARCHITECTS DRAWINGS.
  9. MANHOLE COVERS AND FRAMES SHALL COMPLY WITH THE LA STANDARD PATTERN WITH MIN OPENING OF 600MM & WITH CLOSED KEYWAYS. HEAVY DUTY TYPE A MANHOLES IN ALL TRAFFICKED AREAS AND MEDIUM DUTY TYPE B ELSEWHERE. TO BS EN124. TYPE C MAY BE USED IN ENCLOSED PRIVATE GARDENS.
  10. DOUBLE GULLIES, WITH SEPARATE CONNECTIONS TO MAIN, TO BE PROVIDED AT LOW POINTS AND AT THE ENDS OF CUL DE SACS. MAXIMUM RUN OF PIPE 15M. MINIMUM PIPE DIAMETER 150MM. MAXIMUM GULLY SPACING FOR ROADS UP TO 7M WIDE TO BE 50M UNO.
  11. MANHOLES ON HOUSE DRAINS TO BE IN PRIVATE PROPERTY. HOUSE DRAINS SHALL NOT PASS THROUGH PROPERTY THEY DO NOT SERVE.
  12. RECORD DRAWINGS OF THE AS CONSTRUCTED WORK SHALL BE MADE AVAILABLE TO CORA AT THE END OF THE PROJECT.

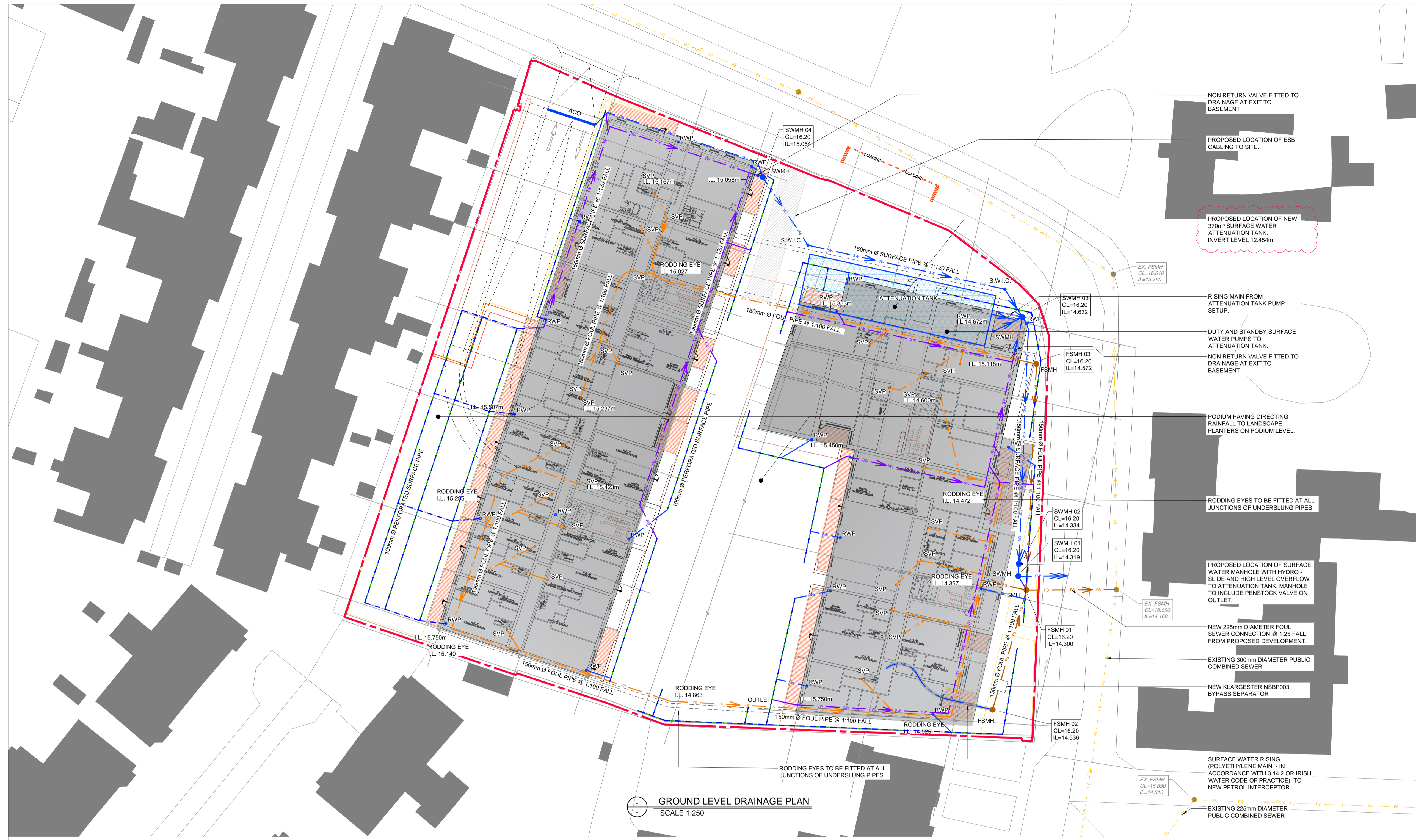

Drawing Stage:  
**PLANNING**

Project Details:	
Site Address:	Europa, Netown Avenue, Blackrock
Client:	Seabren Developments Limited
Architect:	Metropolitan Workshop
M&E Designer:	-
Contractor:	-

Notes

Drawn by:	Checked by:	Approved by:	Date:
BD	AG	JP	13/11/2019
Project Name:	Scale:	Project Number:	
Europa, Blackrock	1:250 @ A1	1953	
Drawing Title:	Project:	Originator:	Zone:
Foul and Surface Water Drainage Ground Floor General Arrangement	-	CORA	-

Behan House,  
10 Lower Mount Street,  
Dublin 2. D02 HT71  
Tel: +353 1 661 1100  
e-mail: info@cora.ie  
Web: www.cora.ie

**CORA**  
CONSULTING ENGINEERS

Level:	Type:	Discipline:	Drawing No:	Stage:	Revision:
-	DR	C	003	P	06