

REV. NO.	REV. DESCRIPTION	REV. DATE	DRAWN	CHECKED
D1	DRAFT ISSUE	21/01/2020	EBR	AG
P1	PLANNING ISSUE	16/04/2020	BD	AG
P02	Notes and Levels Added	08/06/2020	JP	JP
P3	PLANNING UPDATES	08/09/2020	AG	AG
P4	BACKGROUND UPDATED	17/11/2020	AG	AG

DRAINAGE LEGEND	
— FS —	FOUL SEWER (EXISTING)
— FS —	FOUL SEWER (NEW)
— FS —	FOUL SEWER (SLUNG FROM GROUND FLOOR SLAB)
— SW —	SURFACE WATER SEWER (EXISTING)
— SW —	SURFACE WATER (SLUNG FROM GROUND FLOOR SLAB)
— GW —	GREY WATER SEWER (EXISTING)
— GW —	GREY WATER SEWER (NEW)
— RFS —	FOUL SEWER RISING MAIN
— SWS —	SURFACE WATER RISING MAIN
— GWS —	GREY WATER RISING MAIN
---	EXISTING SEWER TO BE DECOMMISSIONED
---	EXISTING WATER MAIN
---	PROPOSED WATER MAIN
---	PROPOSED FLOOD PIPES
●	FSMH (NEW FOUL SEWER MANHOLE)
●	SWMH (NEW SURFACE WATER MANHOLE)
●	NEW FIRE HYDRANT
●	NEW SLUICE VALVE
●	NEW AIR VALVE
●	NEW WASHOUT HYDRANT
●	NEW METER
●	RAIN WATER DOWN PIPE
●	POP UP
●	SOIL VENT PIPE
●	EX. FSMH (EXISTING FOUL SEWER MANHOLE)
●	EX. SWMH (EXISTING SURFACE WATER MANHOLE)
●	MH (EXISTING MANHOLE TO BE DEMOLISHED)
●	F.S.I.C. (FOUL SEWER INSPECTION CHAMBER)
●	S.W.I.C. (SURFACE WATER INSPECTION CHAMBER)
●	E.I.C. (EXISTING INSPECTION CHAMBER)
■	FLOOR GULLY
■	BACK INLET GULLY TRAP
■	ACO DRAINAGE CHANNEL
→	SURFACE WATER EXCEEDANCE FLOW ROUTE

- DRAINAGE NOTES:**
1. READ IN CONJUNCTION WITH ALL RELEVANT ARCHITECTS AND ENGINEER'S DRAWINGS.
 2. MANHOLE AND ROAD GULLY DETAILS TO COMPLY WITH DUN LAOGHAIRE-RATHDOWN COUNTY COUNCIL AND IRISH WATER'S STANDARD DETAILS.
 3. ALL PIPES TO BE WAVIN uPVC OR SIMILAR SAVE FOR SEWERS IN PUBLIC ROADWAY WHICH ARE TO BE CONCRETE.
 4. WHERE COVER TO PIPES IS LESS THAN 1.2M IN ROADS, 1.0M IN PUBLIC AREAS AND 0.8M IN GRASSED/LANDSCAPED AREAS, SURROUND THE PIPE UP TO 150MM WITH 100MM CONCRETE AND LARGER PIPES WITH 150MM CONC.
 5. BACK-FILL TRENCHES IN ROADS WITH MOT STONE COMPACTED IN LAYERS.
 6. CLOSE ROAD GULLIES IN THE DIRECTION OF TRAFFIC FLOW.
 7. ADJUST FOUNDATION DEPTHS, AS NECESSARY, ADJACENT TO SEWERS TO AVOID UNDERMINING OF THE FOUNDATIONS.
 8. DO NOT SET OUT FROM THIS DRAWING. SETTING OUT TO BE DONE FROM ARCHITECTS DRAWINGS.
 9. MANHOLE COVERS AND FRAMES SHALL COMPLY WITH THE LA STANDARD PATTERN WITH MIN OPENING OF 600MM & WITH CLOSED KEYWAYS. HEAVY DUTY TYPE A MANHOLES IN ALL TRAFFICKED AREAS AND MEDIUM DUTY TYPE B ELSEWHERE. TO BS EN124. TYPE C MAY BE USED IN ENCLOSED PRIVATE GARDENS.
 10. DOUBLE GULLIES, WITH SEPARATE CONNECTIONS TO MAIN, TO BE PROVIDED AT LOW POINTS AND AT THE ENDS OF CUL DE SACS. MAXIMUM RUN OF PIPE 15M. MINIMUM PIPE DIAMETER 150MM. MAXIMUM GULLY SPACING FOR ROADS UP TO 7M WIDE TO BE 50M UNO.
 11. MANHOLES ON HOUSE DRAINS TO BE IN PRIVATE PROPERTY. HOUSE DRAINS SHALL NOT PASS THROUGH PROPERTY THEY DO NOT SERVE.
 12. RECORD DRAWINGS OF THE AS CONSTRUCTED WORK SHALL BE MADE AVAILABLE TO CORA AT THE END OF THE PROJECT.

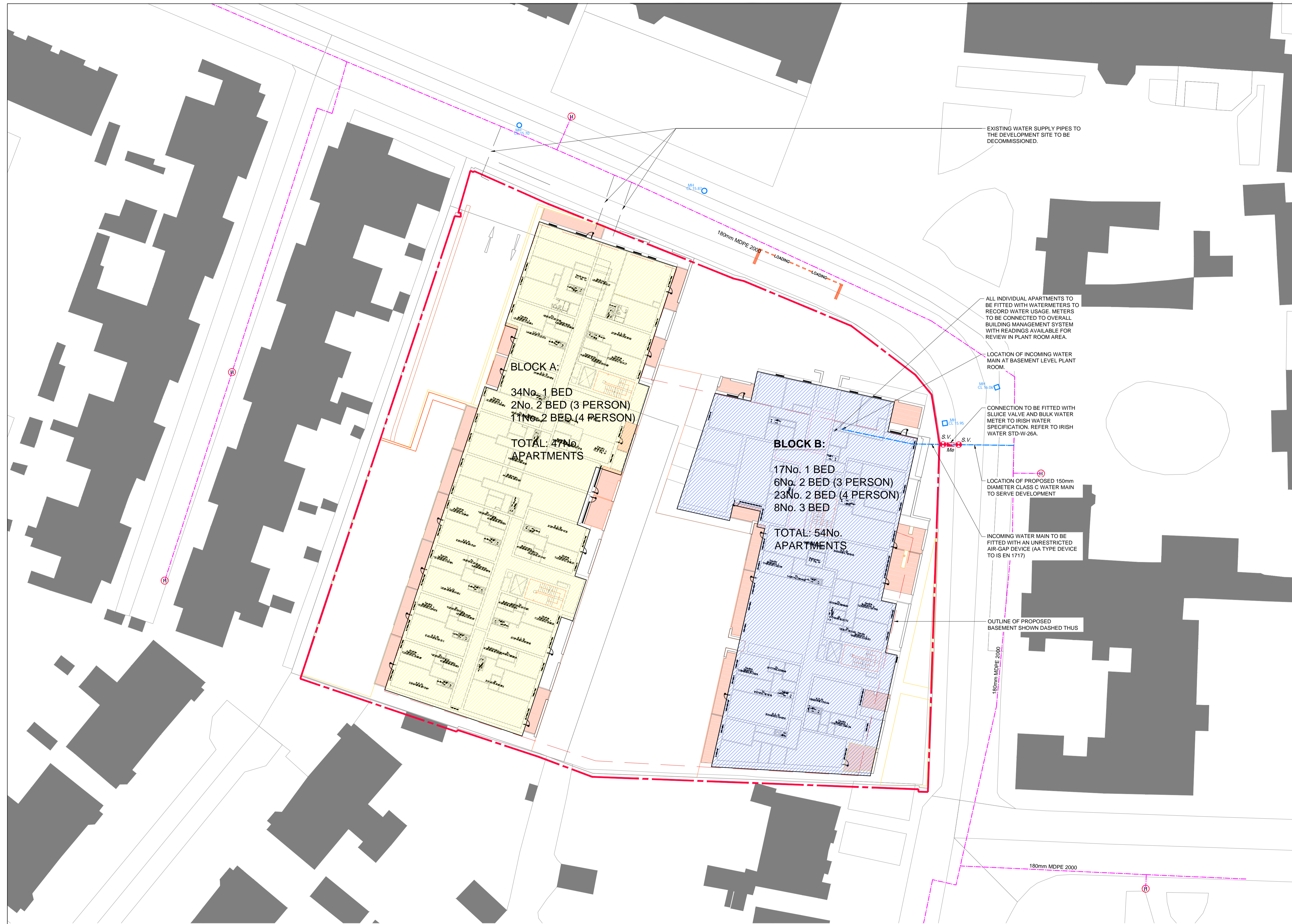

PROPOSED WATERMAIN LAYOUT
SCALE 1:250

Drawing Stage:
PLANNING

Project Details:	
Site Address:	Europa, Netown Avenue, Blackrock
Client:	Seabren Developments Limited
Architect:	Metropolitan Workshop
M&E Designer:	-
Contractor:	-

Notes

Drawn by:	BD	Checked by:	AG	Approved by:	JP	Date:	06/12/2019	
Project Name:	Europa, Blackrock			Scale:	1:250 @ A1	Project Number:	1953	
Drawing Title:	Proposed Watermain General Arrangement		Project:	-	Originator:	CORA	Zone:	-

CORA CONSULTING ENGINEERS

Behan House,
10 Lower Mount Street,
Dublin 2. D02 HT71
Tel: +353 1 661 1100
e-mail: info@cora.ie
Web: www.cora.ie

Level:	Type:	Discipline:	Drawing No:	Stage:	Revision:
-	DR	C	005	P	04